

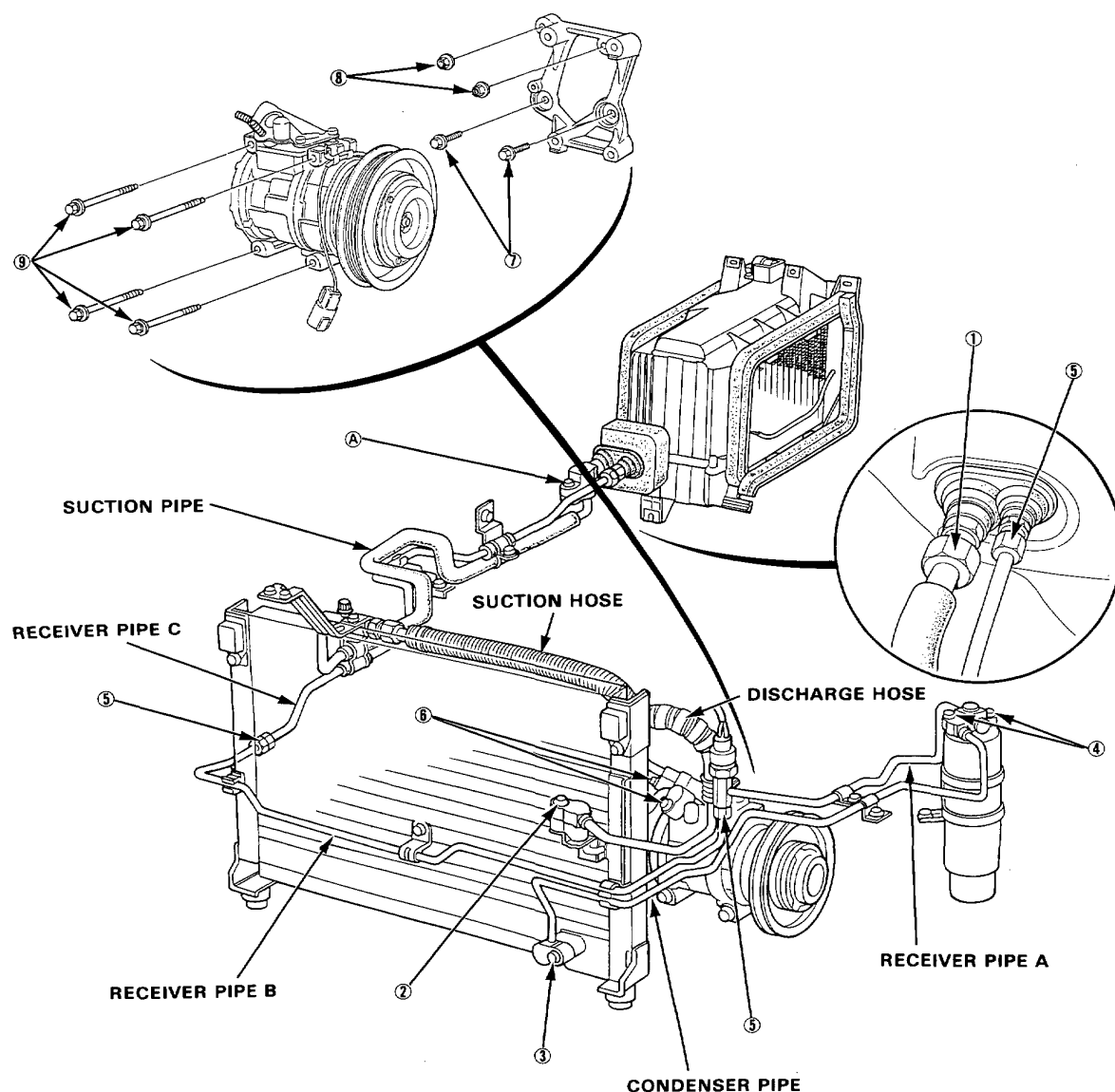

## 10. Torque Specifications.



① Suction hose (evaporator side) .....	32 N·m (3.2 kg-m, 23 lb-ft) [(A) with ALB 30 N·m (3.0 kg-m, 22 lb-ft)]
② Discharge hose to condenser .....	22 N·m (2.3 kg-m, 16 lb-ft)
③ Condenser pipe to condenser .....	22 N·m (2.3 kg-m, 16 lb-ft)
④ Receiver tank .....	17 N·m (1.7 kg-m, 12 lb-ft)
⑤ Receiver pipe A, B, C (both side) .....	17 N·m (1.7 kg-m, 12 lb-ft)
⑥ Compressor hose mounting bolts .....	30 N·m (3.0 kg-m, 22 lb-ft)
⑦ Compressor bracket mounting bolts (10 x 35) .....	50 N·m (5.0 kg-m, 36 lb-ft)
⑧ Compressor bracket mounting nut (8 mm) .....	50 N·m (5.0 kg-m, 36 lb-ft)
⑨ Compressor mounting bolts (8 x 94) .....	25 N·m (2.5 kg-m, 18 lb-ft)

# Belt Tension

## Compressor Belt

- "New belt" refers to a belt which has been used less than 5 minutes on a running engine.
- "Used belt" refers to a belt which has been used on a running engine for 5 minutes or more.

NOTE: Check for belt damage. if necessary, replace the belt.

Belt tension [mm/10 kg]	
New belt	Used belt
8.5~11	10~12

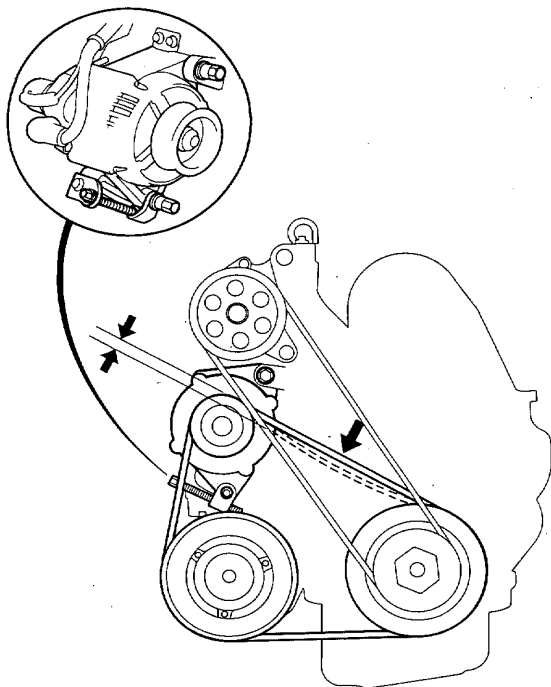

Using ND tension gauge:

Belt tension [kg]	
New belt	Used belt
95~115	45~60

